

°bloc

The first linear lighting system available in a wide variety of high quality materials to offer a solution to your unique requirements.

Interchangeable °bloc units clip onto a surface mounted track.

Design by etre moderne







*bloc.spot, walnut & brass brushed & *bloc, walnut & white carrara
House, Belgium - architect Pascal François - photograph by Thomas De Bruyne (cafeine.be)





°bloc.spot (oak) & °bloc (carrara)











°bloc.spot, bianco carrara & °bloc, oak with custom dye finish
Apartment, Belgium - Rubens-Frederix architecten



°bloc.spot, brushed brass & °bloc, carrara bianco / showroom Lumartes, NYC

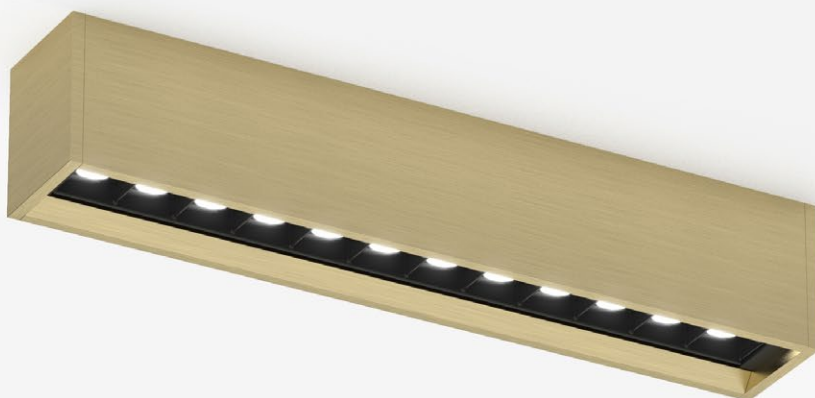

°bloc.spot monopoint - brass anodised aluminum brushed



°bloc.spot monopoint - brass anodised with oak caps



°BLOC.STRIPE brass brushed & °BLOC walnut

House Aalst, Belgium - architect Pascal François - photograph by Jeroen Verrecht



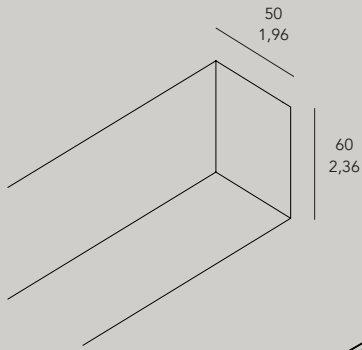

set-up guide

track

bloc spot

300 - 11.81

20° or 40°, both with a black anti-glare louvre

bloc stripe

300 - 11.81

frosted ice or microprism diffuser

bloc stripe

600 - 23.62

frosted ice or microprism diffuser

bloc

300 - 11.81

bloc

600 - 23.62

bloc

900 - 35.43

bloc end

300 - 11.81

bloc end

600 - 23.62

bloc end

900 - 35.43

bloc bevel

55x110

2.16x4.33

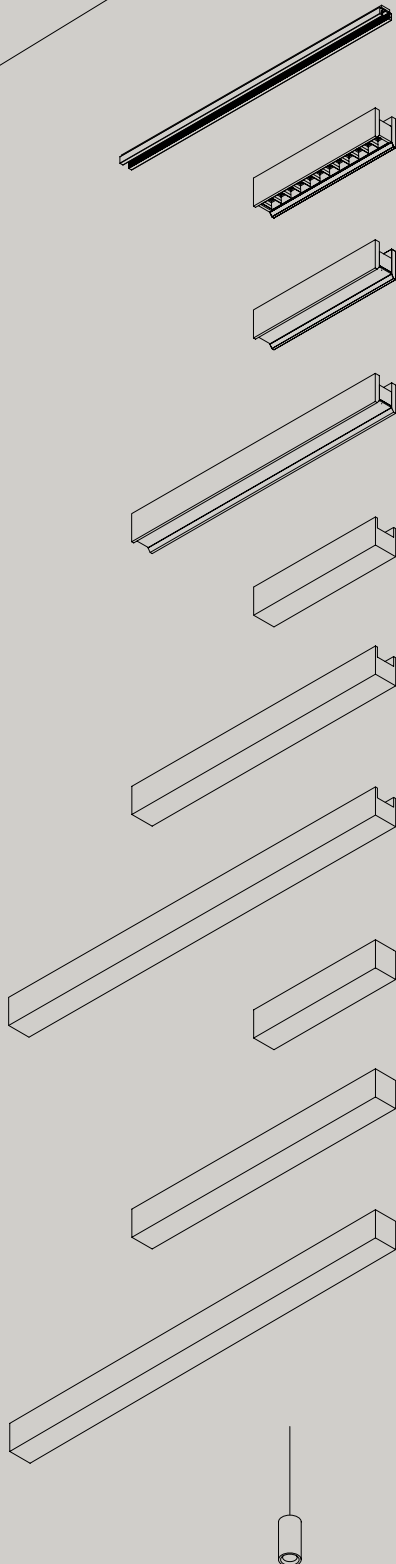

Accessories

- 20252.0000 bloc track pendant 2 m cable suspension (incl cable)
- 20253.0000 bloc track pendant 2 m cable suspension
- 20254.0000 bloc track pendant 2 m bar suspension (incl cable)
- 20255.0000 bloc track pendant 2 m bar suspension

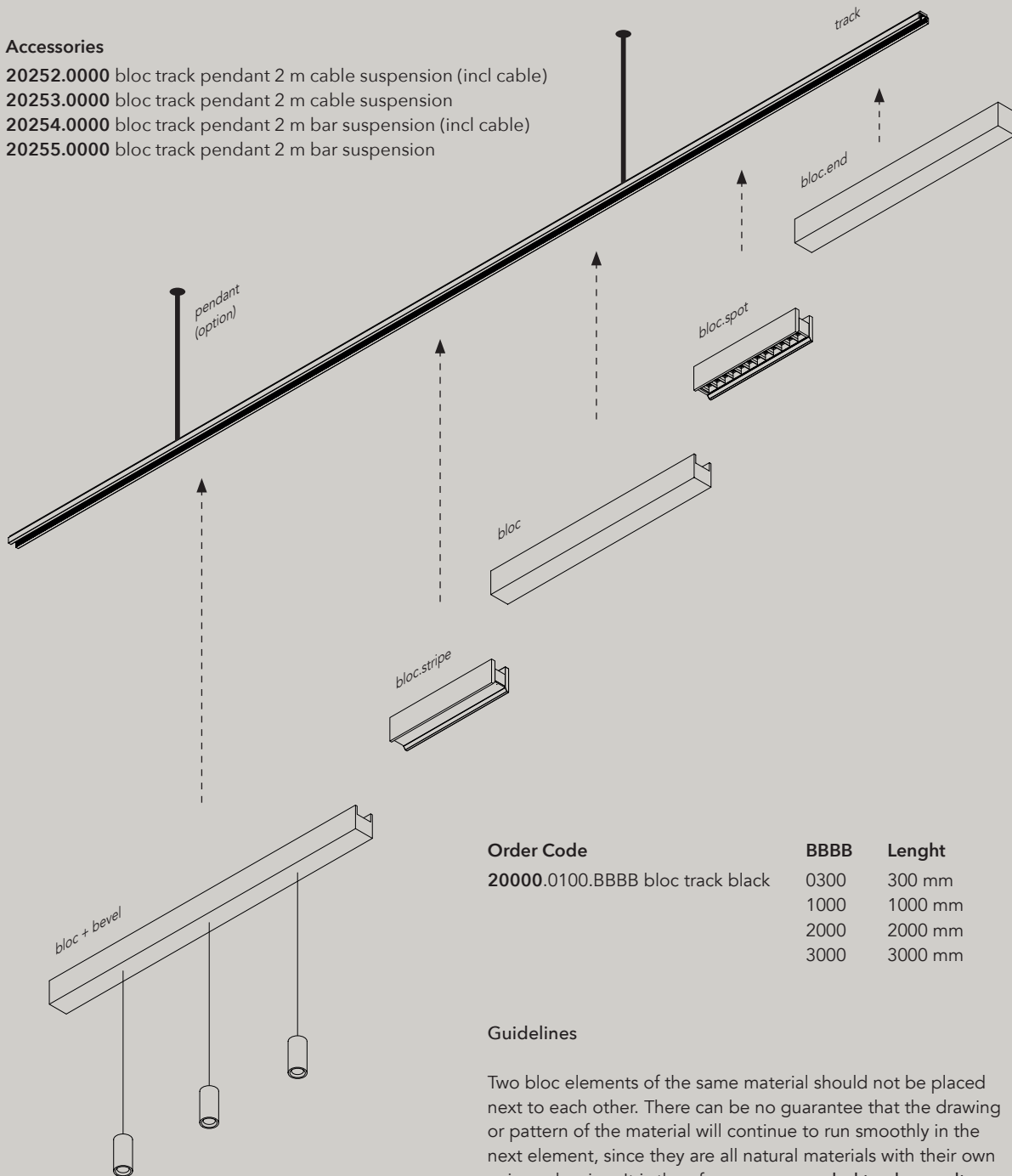

Order Code

20000.0100.BBBB bloc track black

BBBB

0300 300 mm
1000 1000 mm
2000 2000 mm
3000 3000 mm

Lenght

Guidelines

Two bloc elements of the same material should not be placed next to each other. There can be no guarantee that the drawing or pattern of the material will continue to run smoothly in the next element, since they are all natural materials with their own unique drawing. It is therefore **recommended to always alternate between the materials.**

A bloc.stripe or a bloc.spot should be placed between two elements without light (full material). It is **recommended not to place two elements with light next to each other.**

A bloc.spot or bloc.stripe should never be used at the end of the track, unless the end of the track fits against a wall.





°bloc.spot

materials	aluminium coated or anodised / PC
weight	from 0,5-5kg
voltage	48 Vdc
ugr	<10
wattage	13W - 26W (high output)
dimming	DALI, 0-10V, 1-10V, switchDIM, Casambi, Google home & amazon Alexa*
	*from Q3 2020

IP20   



°bloc spot - brass alu anodised brushed + carrara bianco

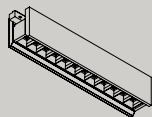

Order Code

20300.AA00.BBBB.CCC.DD bloc spot 300

20301.AA00.BBBB.CCC.DD bloc spot 300 high output*

20302.AA00.BBBB.CCC.DD bloc spot 300 monopoint

20303.AA00.BBBB.CCC.DD bloc spot 300 monopoint high output*

*only available for alu anodised finish

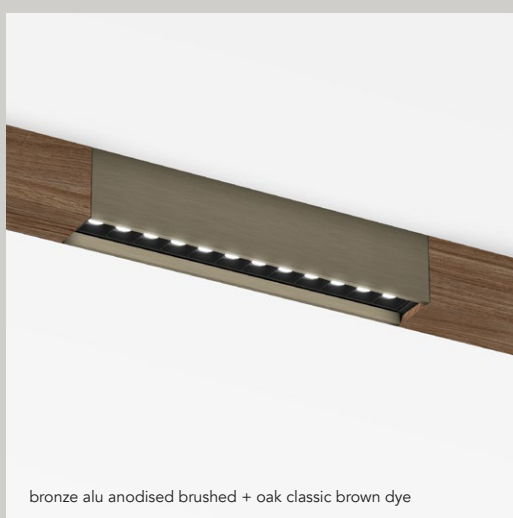
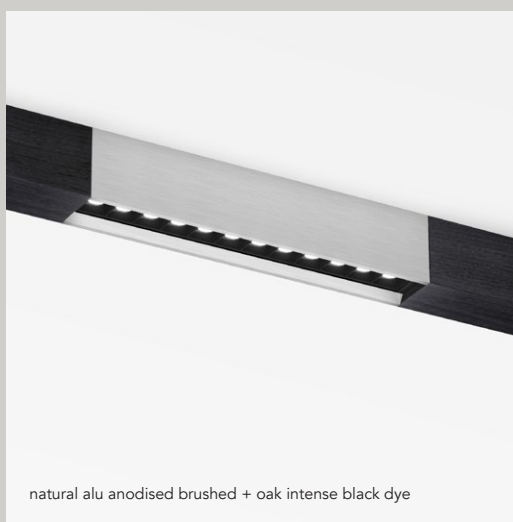

AA	Finish	
01	black	
02	white	
21	black alu anodised brushed	
22	natural alu anodised brushed	
23	brass alu anodised brushed	
25	bronze alu anodised brushed	
26	dark bronze alu anodised brushed	
30	brass brushed	on request
31	brass polished	on request
40	walnut, natural waxed	on request
41	oak natural, natural waxed	on request
42	oak classic brown dye	on request
43	oak intense black dye	on request
61	carrara bianco extra, honed	on request

BBBB	Light
9527	cri >95, 2700K
9530	cri >95, 3000K
9540	cri >95, 4000K - on request

CCC	Optic	Output	High output*
200	20 deg	1090lm - 5650cd	1870lm - 9770cd
300	30 deg	1055lm - 3310cd	1820lm - 5750cd
600	60 deg	1090lm - 1200cd	1870lm - 2060cd

DD	Dimming
ND	no dimming
DA	dali (0/1-10V, switchDIM, Casambi through interface)

* Values for 3000K. Color temperature influences the lumen output.
Download complete photometric data on our website.

°bloc.stripe

materials
weight
voltage
wattage
dimming

aluminium coated or anodised / PC
from 0,5-5kg
48 Vdc
8,2W - 16,4W (high output)
DALI, 0-10V, 1-10V, switchDIM, Casambi, Google home & amazon Alexa*
*from Q3 2020

IP20  CE ENEC



°bloc stripe 300 - brass alu anodised brushed + natural oak



°bloc stripe 600 - brass alu anodised brushed + carrara bianco

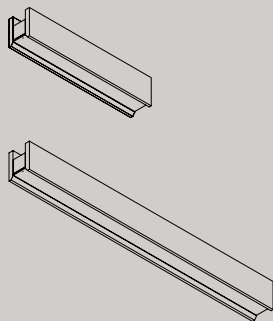

Order Code

20400.AA00.BBBB.CCC.DD bloc stripe 300

20401.AA00.BBBB.CCC.DD bloc stripe 300 high output*

20402.AA00.BBBB.CCC.DD bloc stripe 300 monopoint

20403.AA00.BBBB.CCC.DD bloc stripe 300 monopoint high output*

20410.AA00.BBBB.CCC.DD bloc stripe 600

20411.AA00.BBBB.CCC.DD bloc stripe 600 high output*

20412.AA00.BBBB.CCC.DD bloc stripe 600 monopoint

20413.AA00.BBBB.CCC.DD bloc stripe 600 monopoint high output*

*only available for alu anodised finish

AA	Finish	
01	black	
02	white	
21	black alu anodised brushed	
22	natural alu anodised brushed	
23	brass alu anodised brushed	
25	bronze alu anodised brushed	
26	dark bronze alu anodised brushed	
30	brass brushed	on request
31	brass polished	on request
40	walnut, natural waxed	on request
41	oak natural, natural waxed	on request
42	oak classic brown dye	on request
43	oak intense black dye	on request
61	carrara bianco extra, honed	on request

BBBB	Light
9527	cri >95, 2700K
9530	cri >95, 3000K
9540	cri >95, 4000K - on request

CCC	Optic	Output	High output*
001	frosted ice	880lm - 310cd	1610lm - 560cd
002	microprism	780lm - 370cd	1430lm - 680cd

DD	Dimming
ND	no dimming
DA	dali (0/1-10V, switchDIM, Casambi through interface)

* Values for 3000K. Color temperature influences the lumen output.
Download complete photometric data on our website.

°bloc

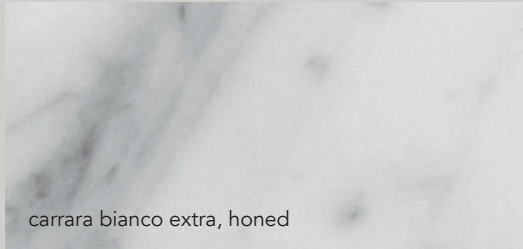

carrara bianco extra, honed

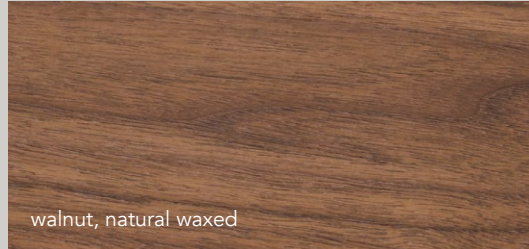

walnut, natural waxed



natural alu anodised



brass alu anodised

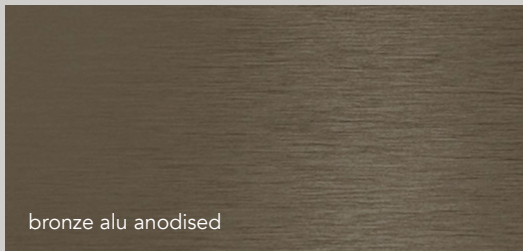

bronze alu anodised

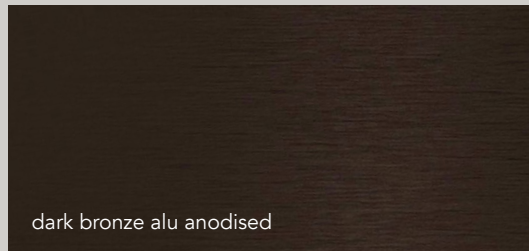

dark bronze alu anodised

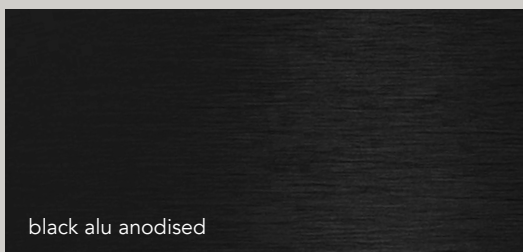

black alu anodised

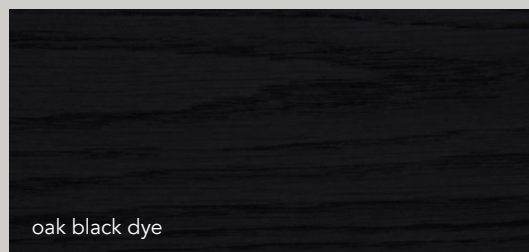

oak black dye



oak natural, natural waxed

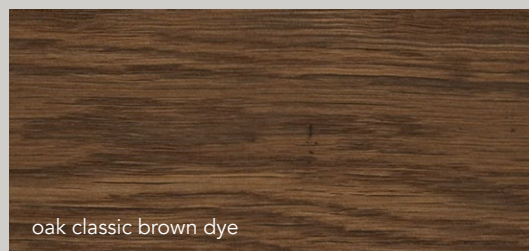

oak classic brown dye

scale 1/1 - Differences in colors and patterns may occur since these are natural materials.

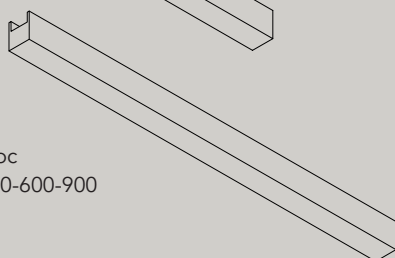
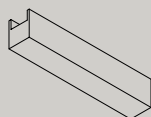

bloc
300-600-900

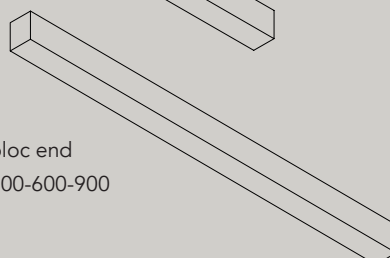
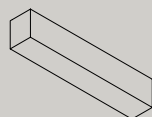

bloc end
300-600-900

Order Code

20600.AA00 bloc 300

20610.AA00 bloc 600

20620.AA00 bloc 900

20601.AA00 bloc 300 end

20611.AA00 bloc 600 end

20621.AA00 bloc 900 end

20602.AA00 bloc 300 end, incl. driver 100W

20612.AA00 bloc 600 end, incl. driver 100W

20622.AA00 bloc 900 end, incl. driver 100W

- custom material on request

- oak can be dyed in reference color

AA

Finish

01 black

02 white

21 black alu anodised

22 natural alu anodised

23 brass alu anodised

25 bronze alu anodised

26 dark bronze anodised

30 brass brushed

31 brass polished

40 walnut, natural waxed

41 oak natural, natural waxed

42 oak classic brown dye

43 oak intense black dye

61 carrara bianco extra, honed

brass polished

brass brushed

° bloc.bevel

materials	aluminium coated or anodised / PC
weight	600gr / 1.32lb
voltage	48 Vdc
wattage	8,2 W
ugr	<19
dimming	DALI, 0-10V, 1-10V, switchDIM, Casambi, Google Home & Amazon Alexa*

*from Q3 2020

IP20   



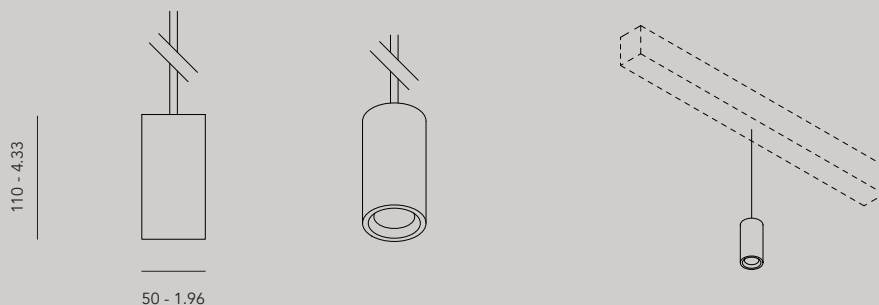

Order Code

20500.AA00.BBBB.CCC.DD bevel

20501.AA00.BBBB.CCC.DD bevel monopoint

°bevel must always be accompanied with a °bloc (see page 141)

max. 1 °bevel on bloc.300

max. 2 °bevel on bloc.600

max. 3 °bevel on bloc.900

AA Finish

- 01 black
- 02 white
- 22 aluminum anodised brushed
- 23 brass anodised brushed
- 25 bronze anodised brushed
- 26 dark bronze anodised brushed

BBBB Light

- 9527 cri 95, 2700K
- 9530 cri 95, 3000K

CCC Optic

300	30°	670lm - 1550cd
450	45°	700lm - 1070cd
600	60°	690lm - 811cd

Output*

DD Dimming

- ND no dimming
- DA dali (0/1-10V, switchDIM, Casambi through interface)

Accessories

- 10150.0100 recessed ceiling rose black, Ø50 mm
- 10150.0200 recessed ceiling rose white, Ø50 mm



* Values for 3000K. Color temperature influences the lumen output.
Download complete photometric data on our website.